

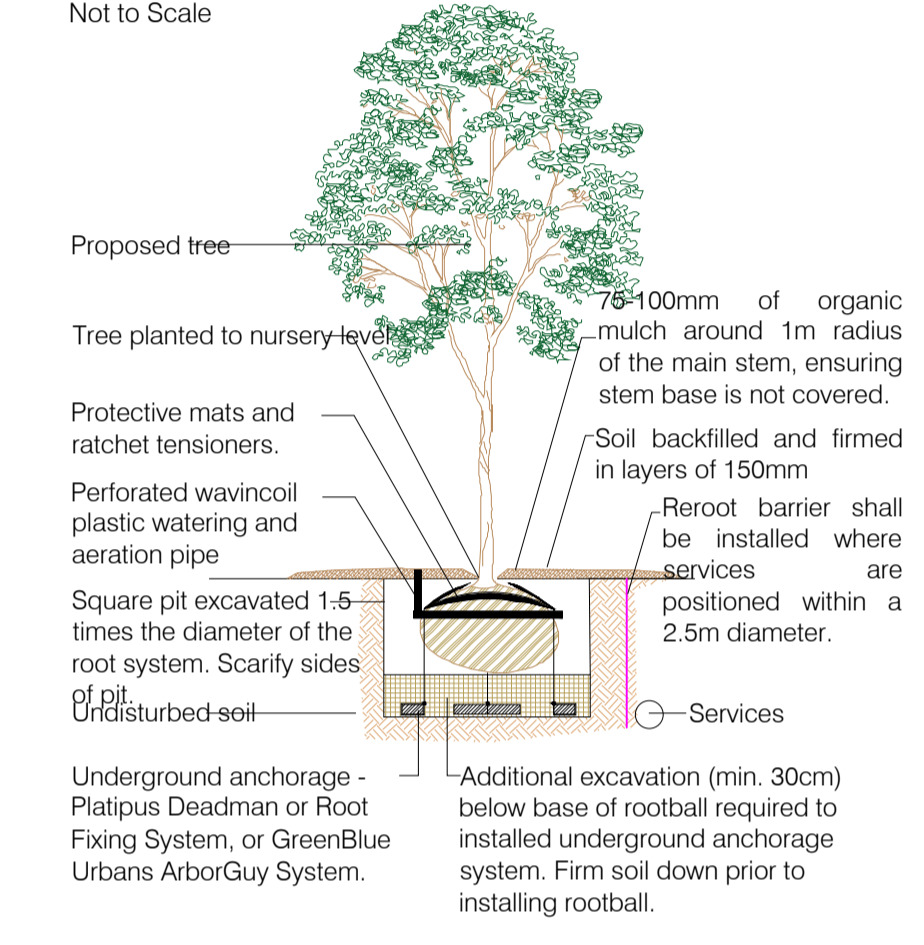

- LEGEND;
- 2.5M RADIUS FROM TREE CENTER POINT. WHERE SERVICES OR HARD LANDSCAPE IS LOCATED WITHIN THE 2.5M ROOT BARRIER MUST BE INSTALLED. ON SITE RANDOMISED INSPECTIONS WILL BE CARRIED OUT BY COUNCIL.
 - 7M RADIUS FROM CENTER LIGHT FIXTURE NO LARGE TREES TO BE PLANTED WITHIN RADIUS
 - SURFACE WATER DRAINAGE
 - FOUL WATER DRAINAGE
 - EXISTING FOUL WATER DRAINAGE
 - WATERMAIN ϕ 200mm
 - WATERMAIN ϕ 150mm
 - WATERMAIN ϕ 100mm
 - ATTENUATION AREA
 - FIRE HYDRANT

Detail 1: Tree Planting Underground Guying
Not to Scale



Detail 2: Standard Rootball Tree Planting Specification
Not to Scale

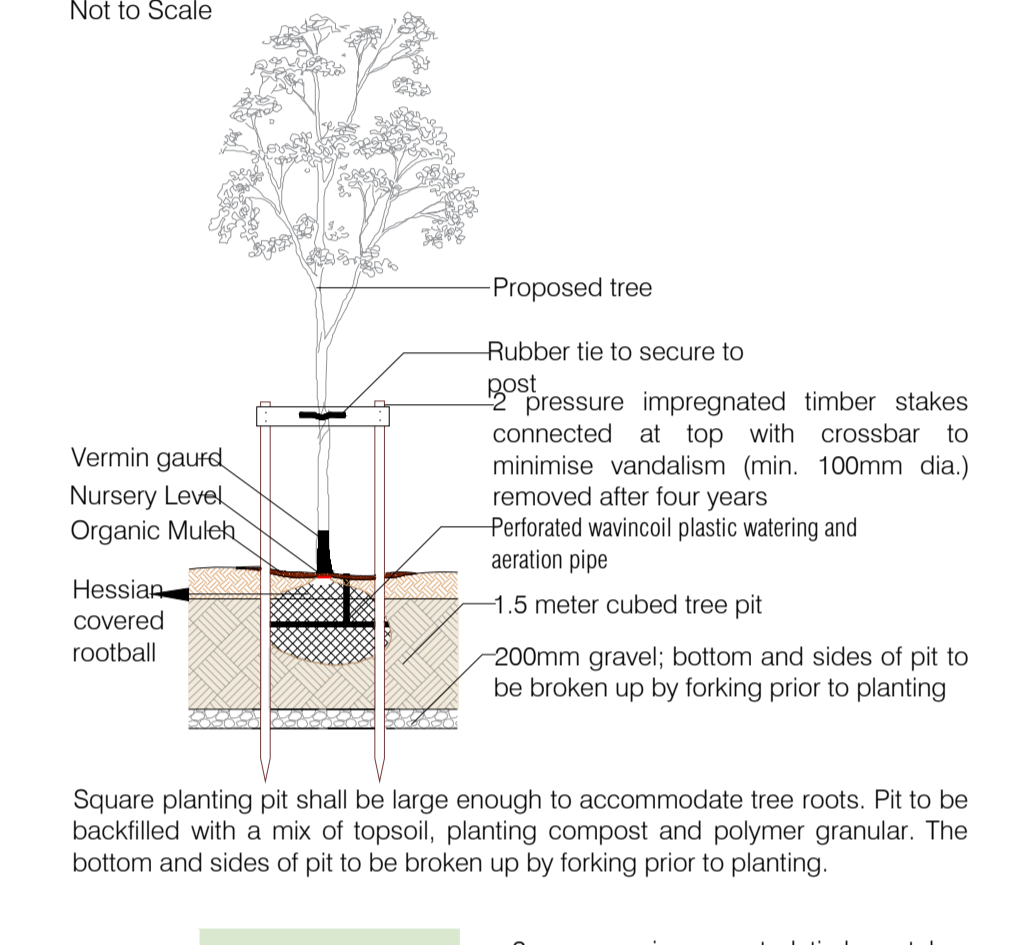

Single stake 12-14cm with Root barrier
Not to Scale

